



AWARDED FOR  
MARKETING | SERVICE | RESULTS



187 Wilmslow Road  
Heald Green SK8 3BG  
£425,000

MAIN  
M&IN

SALES · LETTINGS · AUCTIONS

MAINANDMAIN.CO.UK



# 187 Wilmslow Road Heald Green SK8 3BG

£425,000

Standing well back from Wilmslow Road, this semi-detached residence features a front garden area behind an extensive driveway, which provides plentiful off road parking space. This is in addition to a further two car driveway accessed from Bradshaw Hall Lane which leads on to a single garage.

Much improved by the current owner, this well-presented home offers stylish and versatile accommodation, likely to appeal to a wide range of potential buyers.

An entrance hallway leads to a well-proportioned living room, which opens on to an impressive open-plan dining kitchen, with modern units and large bi-folding doors to the rear garden.

Also to the ground floor is a family bathroom and a room which could suit use as an additional reception room, or as a third bedroom, dependent upon preference.

To the first floor a landing leads to two good double bedrooms, both with fitted wardrobes and each with an en-suite shower room/WC.

To the rear of the property is an attractive garden with raised deck providing seating and entertaining space. There is a lawned section, decorative borders and a storage shed. Gated access provides a route to the rear of the aforementioned single garage.

This most appealing home is well-placed for access to amenities, popular local schools and transport network connections. An internal inspection is essential in order to fully appreciate all that this property has to offer.

- Spacious Semi-Detached Residence
- Versatile Living Space
- Stylish Open-Plan Dining Kitchen with Bi-fold Doors
- Three Bedrooms
- Three Bathrooms
- Two Driveways - Space for 8 Vehicles
- Single Garage
- Attractive Gardens
- Popular Location
- Viewing Essential

Entrance Hallway  
13'5 max x 5'5

Living Room  
13'5 x 10'11  
Open to:

Dining Kitchen  
9'9 x 26'11

Sitting Room/Bedroom Three  
10'0 x 9'11

Bathroom  
6'6 x 7'11

First Floor Landing

Bedroom One  
16'5 x 10'8 to fitted wardrobes red to 9'0

En-suite Shower Room/WC  
9'1 x 3'2

Bedroom Two  
13'2 red to 10'0 x 10'1 max

En-suite Shower Room/WC  
5'8 max x 5'7

Externally  
Extensive driveway to the front of the property, affording parking space for numerous vehicles.

Garden area immediately in front of the house.  
Enclosed rear garden with raised deck, lawn, decorative borders, storage shed.

Pedestrian access to the rear of the single garage (16'6 x 8'5), the front entrance of which is accessed from Bradshaw Hall Lane.

In front of the garage is a long driveway, allowing space for another two vehicles.



Tenure: Freehold  
Council Tax: Stockport D

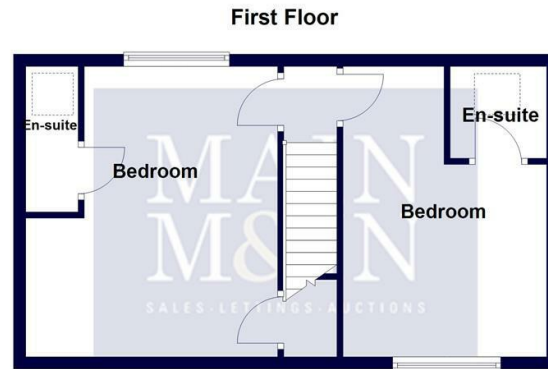

For Illustration Purposes Only. Not To Scale  
Plan produced using PlanUp.

187 Wilmslow Road, Cheadle

To view this property call Main & Main on 0161 437 1338

